

GENERAL

Detection	Equipped for magnetic position detectors
Fluid	Air or neutral gas, filtered, lubricated or not
Operating pressure	2 to 10 bar max.
Ambient temperature	-20°C to +70°C
Max. speed	0,5 m/s
Standards	AFNOR NF E 49-004

CONSTRUCTION

Body	Aluminium alloy
Rod	Stainless steel
Rod end	Tapped (threaded rod end: see accessories)
Piston	POM (polyacetal) or light alloy fitted with a permanent annular magnet
Piston seals	PUR (polyurethane)
Bearing	Self lubricating
Mounting	Front or rear with screw (not supplied)



B

SPECIFICATIONS

SIMPLE ACTING CYLINDER - NF E 49-004-1
Minimum pressure to compress the spring: according to NF E 49-004 standards
The return of the piston rod must be without load

Ø (mm)	extend force at 6 bar (daN)	retract force (daN)	catalogue number	reference (2)	standards stroke (mm)				connection Ø
					5	10	15	20	
Single acting cylinder - rod returned at rest (R)									
20	14	1,2	44250001 (1)	KN 20 R (1) DM	●	●	●		M5
25	24	1,6	44250002 (1)	KN 25 R (1) DM	●	●	●	●	M5
Single acting cylinder - rod out at rest (S)									
20	12	1,2	44250009 (1)	KN 20 S (1) DM	●	●	●		M5
25	19	1,6	44250010 (1)	KN 25 S (1) DM	●	●	●	●	M5

DOUBLE ACTING CYLINDER - NF E 49-004-2

Ø (mm)	catalogue number	reference (2)	standards stroke (mm)							max. stroke capability (mm)	Ø port	
			5	10	15	20	25	30	40			50
Double acting cylinder - single rod												
20	44250017 (1)	KN 20 D (1) DM	●	●	●	*	*	*	*	*	60	M5
25	44250018 (1)	KN 25 D (1) DM	●	●	●	●	*	*	*	*	90	M5
Double acting cylinder - through rod												
20	44250025 (1)	KN 20 D (1) T2-DM	●	●	●	*	*	*	*	*	60	M5
25	44250026 (1)	KN 25 D (1) T2-DM	●	●	●	●	*	*	*	*	90	M5

(1) Indicate stroke (in mm) preferably selecting one of the standard strokes above. Other strokes on request (min.: 5 mm, max.: 25 mm)
(2) **The magnetic position detectors must be ordered separately:** UNI model, reed switch or magneto-resistive type (see page P295) or COMPACT model, reed switch or magneto-resistive type (see page P293)

Specifications for use: see installation leaflet
Tolerance on stroke length according to NF E 49-004 standards
Other bores : see page P226 - PEC cylinders

● Recommended strokes according to NF E 49-004
* Other strokes available as standard

OPTIONS

- Version with rotation-proof device on the bearing-rod (see page 6)
- Version non equipped for use with magnetic position detector
- Version with threaded rod end: procure male threaded rod end fitting (see accessories)

ACCESSORIES: see following pages

DIMENSIONS (mm), WEIGHT (kg) 
Single and double acting cylinders

tapped rod end

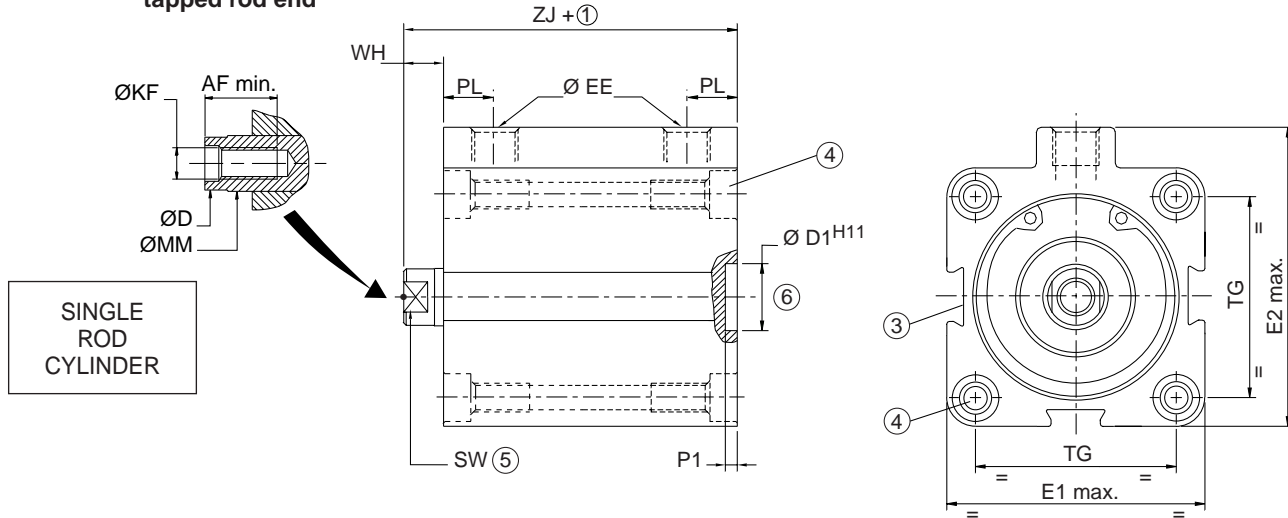

**SINGLE
ROD
CYLINDER**

**THROUGH
ROD
CYLINDER**

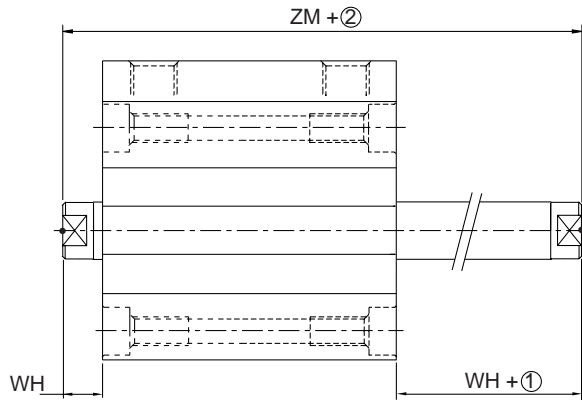

- ① Stroke.
For non-standard strokes, take the next higher standard one.
- ② 2 x stroke
- ③ Ø 20 - 25 mm = 1 track per face
- ④ Mounting holes and counterbores (see detailed view below and following pages)
- ⑤ Dimensions across flats
- ⑥ Standard countersinking for centring at rear

Ø	AF	BG	ØD	ØD1	ØD2	EE	E1	E2	ØKF	ØMM	PL	P1	ØRR	RT	SW	TG	TK	WH	ZJ	ZM	weight	
																					(7)	(8)
20	10	15	9,8	12	8	M5	36	44	M6x1	10	7,8	2,5	4,2	M5	8	22	4,7	6	43	49	0,082	0,0022
25	10	15	9,8	12	8	M5	40	48	M6x1	10	9,3	2,5	4,2	M5	8	26	4,7	6	45	50,5	0,125	0,0028

Tolerance on dimensions according to NF E 49-004 standards

(7) Cylinder weight with 0 mm stroke.

(8) Weight to be added per additional mm length.

Mounting

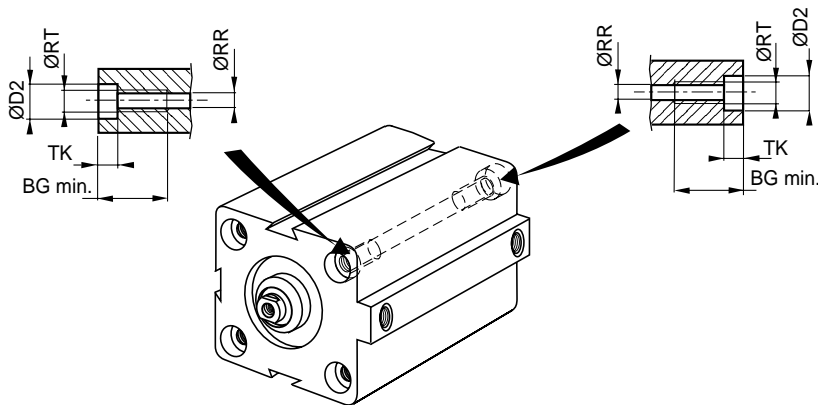

ENCOMBREMENTS (mm)

The tapped and sunten mounting holes provide great flexibility for mounting. The tappings simplify securing the cylinders.

• **Front mounting**

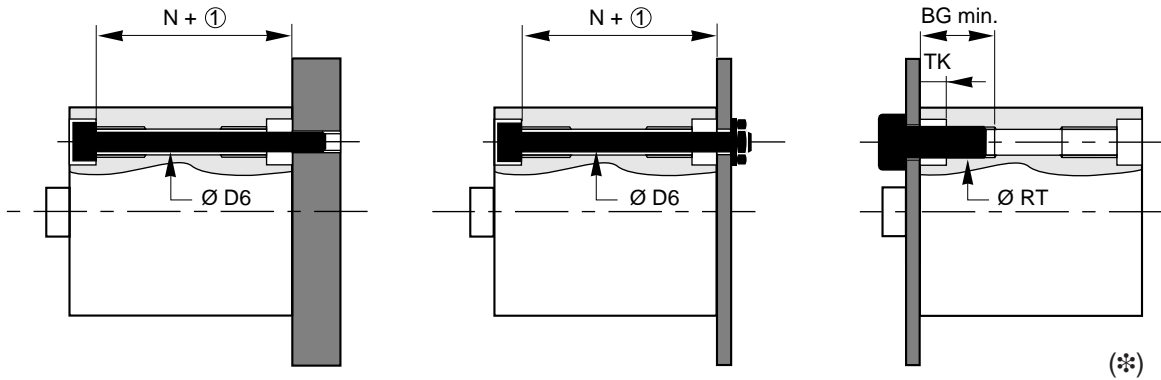

• **Rear mounting**

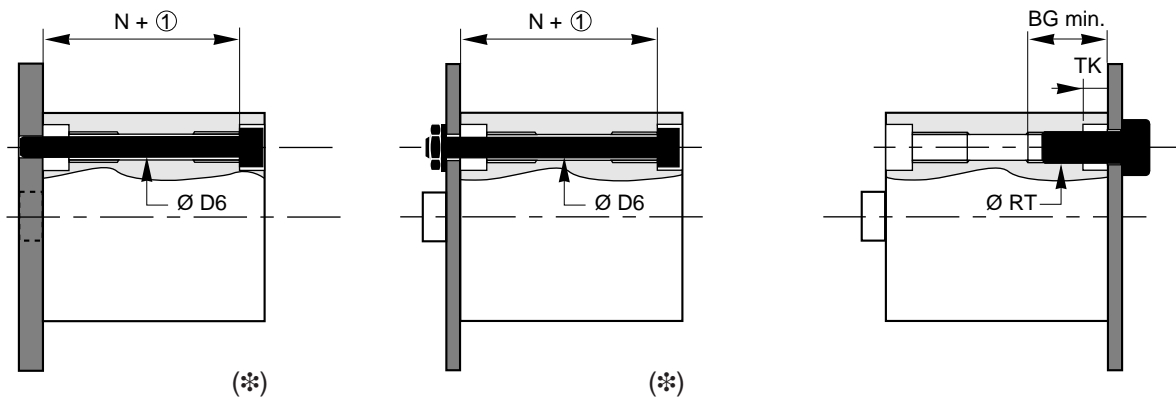

Ø	BG min.	Ø D6	Ø RT	N	TK
20	15	M4	M5	32,3	4,7
25	15	M4	M5	34,3	4,7

- ① Stroke.
For non-standard strokes, take the next higher standard one.
- (*) Type of mounting not realizable on anti-rotation version

B

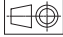
DIMENSIONS (mm), WEIGHT (kg) 

Threaded end piece / KN

Threaded rod endfitting for the tapped rod end of standard 20 and 25 mm bore cylinders.

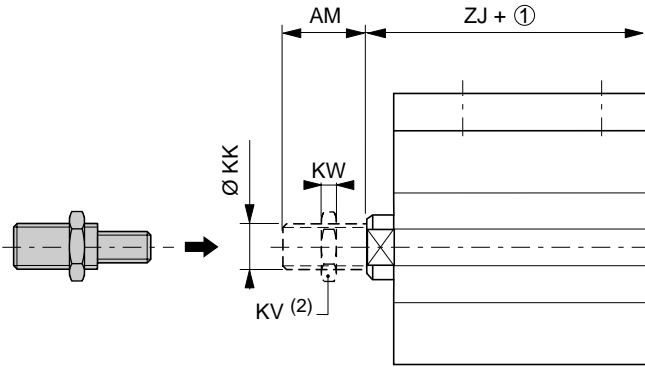

- ① Stroke.
For non-standard strokes,
take the next higher standard one.
- ② Dimensions on flats

Ø	code threaded end piece	AM	Ø KK	KV	KW	ZJ +
20	43400481	20	M8x1,25	13	4	43
25						45

In your order, indicate the code of the end piece, which is supplied **separately**.

Female rod clevis - AP2 (ISO 8140)

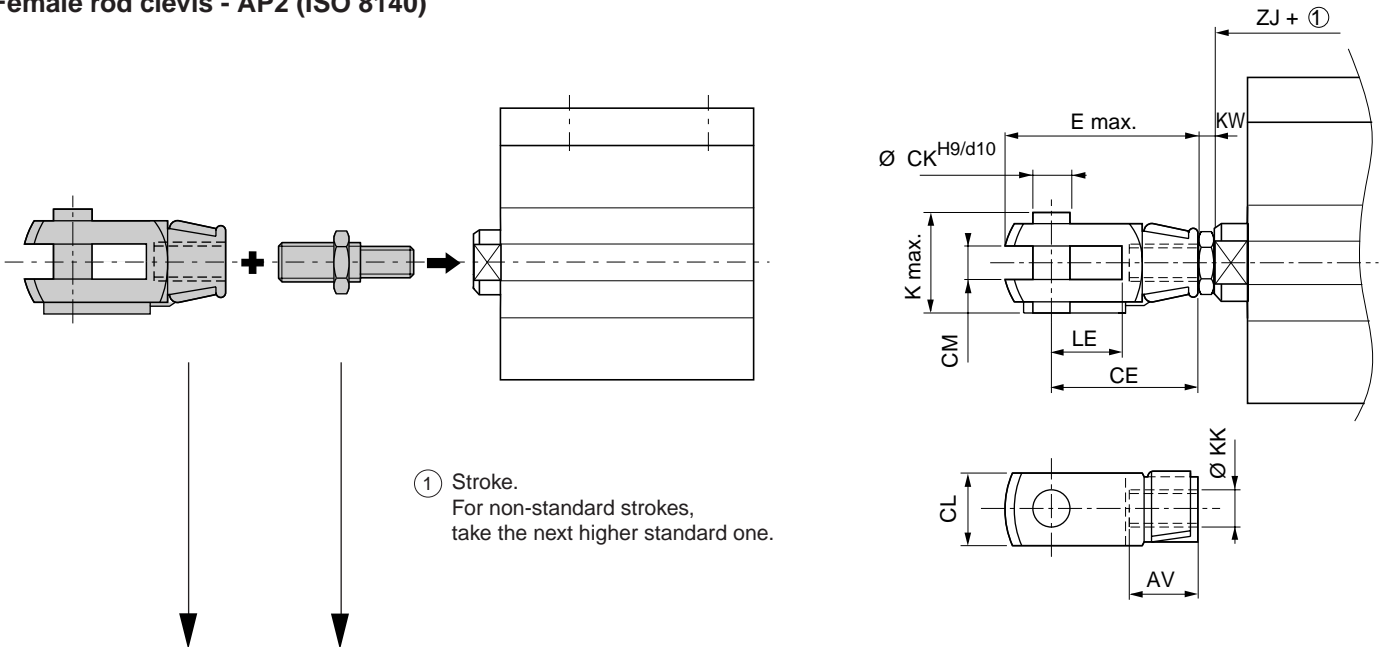

- ① Stroke.
For non-standard strokes,
take the next higher standard one.

Ø	code female rod clevis AP2	code threaded end piece	AV	CE	Ø CK	CL	CM	E	K	Ø KK	LE	ZJ	clevis weight
20	43900161	43400481	16	32	8	16	8 ^{+0,5} _{+0,15}	45	22	M8x1,25	16	43	0,050
25												45	

Please indicate the threaded and clevis end piece code in your order. These two items are supplied not installed on the cylinder.

DIMENSIONS (mm), WEIGHT (kg)

Spherical bearing rod end - AP6 (ISO 8139)

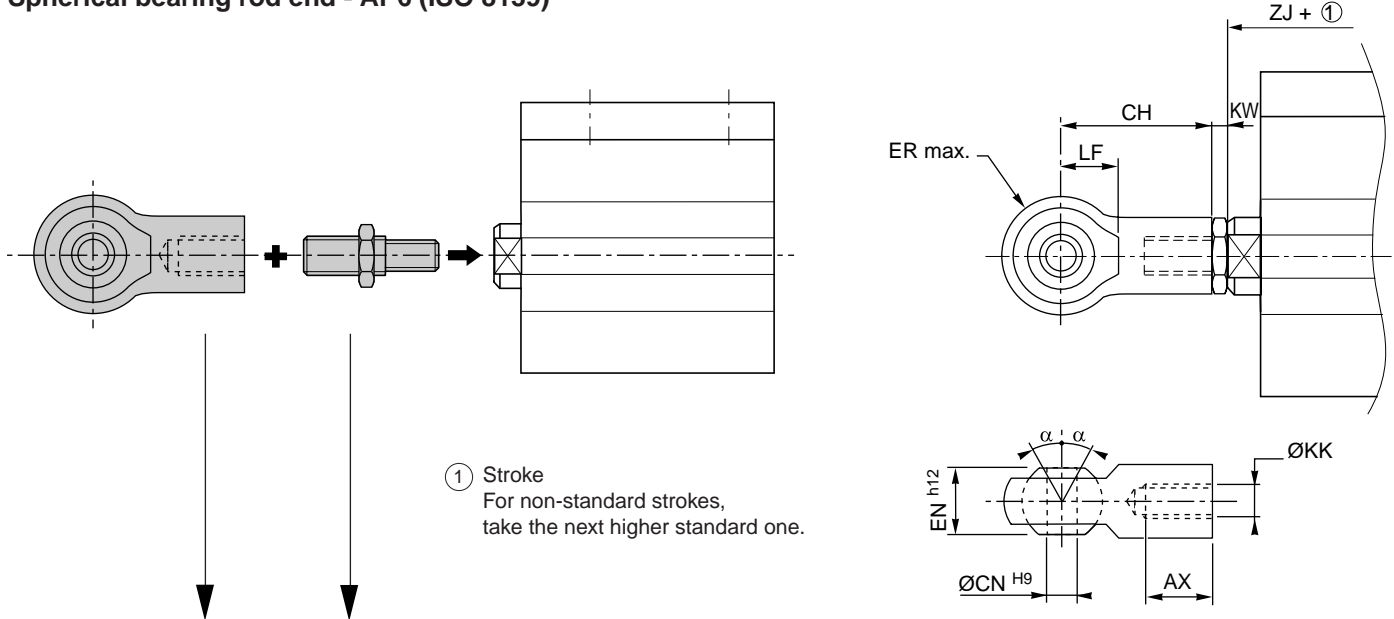

① Stroke
 For non-standard strokes,
 take the next higher standard one.

Ø	code spherical rod end AP6	code threaded rod end	AX	CH	CN	EN	ER	LF	Ø KK	ZJ	α	spherical bearing weight
20	43900187	43400481	16	36	8	12	12	13	M8x1,25	43	4°	0,050
25										45		

Please indicate the threaded and spherical bearing end piece code in your order.
 These two items are supplied not installed on the cylinder.
 NOTA: Alignment compensator rod end, see page P242-8

B