







Industrial valves









Industrial valves selection guide

Type	Direct-operated				Servo-operated		
	EV210B	EV310B	EV210A	EV310A	EV220B 6 - 22	EV220B 15 - 50	EV224B
Ordering information found in this catalog on page	9				11	13	
							
Process connection	1/8" to 1/2" NPT or BSPP	1/8" to 3/8" BSPP or flange	1/8" to 1/4" BSPP or flange	1/8" to 1/4" BSPP or flange	1/4" to 1" NPT or BSPP	1/2" to 2" NPT or BSPP	1/2" to 2" NPT or BSPP
Function	NC or NO	NC or NO	NC or NO	NC or NO	NC or NO	NC or NO	NC or NO
Orifice size	1.5 to 10mm (1/16" to 3/8")	1.5 to 3.5mm (1/16" to 9/64")	1.2 to 3.5mm (3/64" to 9/64")	1.2 to 2.0mm (3/64" to 5/64")	6.4 to 19.1mm (1/4" to 3/4")	14.3 to 50.8mm (9/16" to 2")	19 to 25.4mm (3/5" to 1")
Flow factor	Kv=0.05 to 1.5 m3/hr (Cv=0.06 to 1.8 UsGal/min)	Kv=0.08 to 0.4 m3/hr (Cv=0.09 to 0.47 UsGal/min)	Kv=0.04 to 0.26 m3/hr (Cv=0.05 to 0.31 UsGal/min)	Kv=0.04 to 0.08 m3/hr (Cv=0.05 to 0.09 UsGal/min)	Kv=0.7 to 6 m3/hr (Cv=0.8 to 7 UsGal/min)	Kv=4 to 40 m3/hr (Cv=4.7 to 46.8 UsGal/min)	Kv=4 to 11 m3/hr (Cv=4.7 to 12.9 UsGal/min)
Opening differential pressure	0 to 20 bar (0 to 290 psi)	0 to 20 bar (0 to 290 psi)	0 to 30 bar (0 to 435 psi)	0 to 20bar (0 to 290 psi)	0.1 to 10 bar (1.45 to 145 psi)	0.3 to 10 bar (4.35 to 145 psi)	0.3 to 40 bar (4.35 to 580 psi)
Media temperature	-10° to 90°C (14° to 194°F)	-10° to 100°C (14° to 212°F)	-30° to 120°C (-22° to 248°F)	-10° to 100°C (14° to 212°F)	-10° to 90°C (14° to 194°F)	-10° to 100°C (14° to 212°F)	-10° to 60°C (14° to 140°F)
Valve body material	Brass or St.steel	Brass or St.steel	Brass or St.steel	Brass or St.steel	Brass or DZR Brass	Brass, DZR Brass or St.steel	Brass or St.steel
Internal parts material	St.steel	St.steel	St.steel	St.steel	St.steel	St.steel	St.steel
Seal material ¹⁾	EPDM or FKM	FKM	EPDM or FKM	FKM	EPDM or FKM	EPDM, FKM or NBR	EPDM, FKM or NBR
Approvals	CE, UL, CSA and Marine	CE	CE	CE	CE, UL, CSA and Marine	CE, UL, CSA and Marine	CE
Can be used together with:							
Coil type	BA**, BT, BU or BY**	BA**	AB**, AC**, AK**, AM** or AP**	AB**, AC**, AK** or AM	BA, BT, BU or BY**	BA, BT, BU or BY**	BT, BU or BY**

** Requires DIN connector

Medium	EPDM ¹⁾	FKM ¹⁾	NBR ¹⁾	PTFE ¹⁾
Water/glycols	-30° to 140°C (-22° to 284°F)	0° to 60°C, 0° to 100°C (32° to 140°F, 32° to 212°F)	-10° to 90°C (14° to 194°F)	
Oil		0° to 100°C (32° to 212°F)	-10° to 90°C (14° to 194°F)	
Air		0° to 100°C (32° to 212°F)	-10° to 90°C (14° to 194°F)	
Steam	<140°C (284°F)			<185°C (365°F)

¹⁾ Seal material

				Proportional	Externally operated	
Type	EV225B	EV250B	EV220A	EV260B	AV210	AVTA
Ordering information found in this catalog on page	15	17		19		25
						
Process connection	1/4" to 1" NPT or BSPP	3/8" to 1" NPT or BSPP	1/4" to 1" NPT or BSPP	1/4" to 3/4" NPT or BSPP	1/2" to 2" NPT or BSPP	1/2" to 2" NPT or BSPP
Function	NC	NC or NO	NC or NO	NC	NC or NO	Proportional
Orifice size	3.2 to 25.4mm (1/8" to 1")	9.5 to 25.4mm (3/8" to 1")	6 to 22mm (15/64" to 7/8")	6.4 to 19.1mm (1/4" to 3/4")	12.7 to 50.8mm (1/2" to 2")	9.4 to 25.4mm (2/5" to 1")
Flow factor	Kv=0.3 to 6 m3/hr (Cv=0.35 to 7 UsGal/min)	Kv=2.5 to 7 m3/hr (Cv=2.9 to 8.2 UsGal/min)	Kv=1 to 7 m3/hr (Cv=1.18 to 8.24 UsGal/min)	Kv=0.8 to 5.0 m3/hr (Cv=0.94 to 6.0 UsGal/min)	Kv=5.7 to 74 m3/hr (Cv=6.7 to 86.6 UsGal/min)	Kv=2.59 to 7.53 m3/hr (Cv=2.2 to 6.4 UsGal/min)
Opening differential pressure	0 to 10 bar (0 to 145 psi)	0 to 10 bar (0 to 145 psi)	0.2 to 16 bar (2.9 to 232 psi)	0.5 to 10bar (7 to 145psi)	0 to 16 bar (0 to 232 psi)	0 to 10 bar (0 to 145 psi)
Media temperature	Max. 184°C (364°F)	-10° to 90°C (14° to 94°F)	-22° to 100°C (14° to 212°F)	-10° to 80°C (14° to 176°F)	-30° to 180°C (-22 to 356°F)	-25° to 130°C (-13° to 266°F)
Valve body material	DZR Brass	DZR Brass	Brass	Brass	Bronze or St. steel	Brass or St. steel
Internal parts material	St. steel	St. steel	St. steel	St. steel	St. steel	Brass or St. steel
Seal material ¹⁾	PTFE	EPDM or FKM	EPDM or FKM	PTFE	PTFE	EPDM or FKM
Approvals	CE, UL and Marine	CE, UL and Marine	CE	CE	CE	CE
Can be used together with:						
Coil type	BR, BT or BU	BT, BU or BY**	AB**, AK**, AM** or AP**	BK, BK or BM		

EV210B



Direct-operated 2/2-way solenoid valves

- Normally closed (NC) and normally open (NO) versions
- High opening degree at zero or low differential pressures
- Increased performance without increasing the coil power
- Long lifetime
- Insensitive to dirt
- Increased resistance against corrosion and cavitation with stainless steel version
- Isolating diaphragm available as accessory for secure opening and closure



Technical data

Opening differential pressure	0-20 bar (0 to 290 psi)
Ambient temperature	Max. 50°C (120°F)
Media temperature	-10° to 90°C (14° to 194 °F)
Orifice sizes	1.5 to 10 mm (1/16" to 3/8")
Process connection	1/8" to 1/2" NPT or BSPP
Body material	Brass or Stainless Steel
Seal material	EPDM or FKM
Enclosure	Up to IP67 / NEMA 6 (depending on coil and connector)

Dimensions and weight

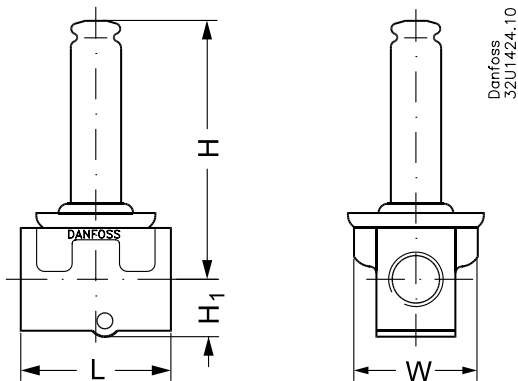

Type	H (NC)		H (NO)		W	
	mm	in	mm	in	mm	in
EV210B 1.5 (1/8" connection)	70	2.8	75	3.0	34	1.3
EV210B 1.5 (1/4" connection)	70	2.8	-	-	34	1.3
EV210B 2	70	2.8	-	-	34	1.3
EV210B 3	71	2.8	76	3.0	34	1.3
EV210B 6	74	2.9	-	-	43.5	1.8
EV210B 10	77	3.0	-	-	48	1.9

Type	L		H1		Weight	
	mm	in	mm	in	kg	lbs
EV210B 1.5 (1/8" connection)	35.6	1.4	12.7	0.5	0.14	0.3
EV210B 1.5 (1/4" connection)	39	1.5	12.7	0.5	0.14	0.3
EV210B 2	35.6	1.4	12.7	0.5	0.14	0.3
EV210B 3	40.6	1.6	12.7	0.5	0.18	0.4
EV210B 6	45.7	1.8	12.7	0.5	0.23	0.5
EV210B 10	58.4	2.3	12.7	0.5	0.27	0.6

Ordering - EV210B

Versions normally closed

Type	Process Connection	Orifice size		Flow factor		Opening differential pressure		Code no.**
		mm	in	Kv (m ³ / hr)	CV (US Gal/min)	bar	psi	FKM
EV210B 1.5	1/8 - 27 NPT	1.5	1/16	0.05	0.06	0 to 20	0 to 290	032U6501
EV210B 1.5	1/4 - 14 NPT	1.5	1/16	0.05	0.06	0 to 20	0 to 290	032U6502
EV210B 2	1/8 - 27 NPT	2	1/12	0.15	0.18	0 to 20	0 to 290	032U6503
EV210B 3	1/4 - 14 NPT	3	1/8	0.3	0.35	0 to 20	0 to 290	032U6505
EV210B 3	3/8 - 18 NPT	3	1/8	0.3	0.35	0 to 20	0 to 290	032U6506
EV210B 6	3/8 - 18 NPT	6	1/4	0.7	0.82	0 to 1.2	0 to 17	032U6565
EV210B 10	1/2 - 14 NPT	10	3/8	1.5	1.80	0 to 0.8	0 to 11	032U6567

Ordering - EV210B

Versions normally open

Type	Process Connection	Orifice size		Flow factor		Opening differential pressure		Code no.**
		mm	in	Kv (m ³ / hr)	CV (US Gal/min)	bar	psi	FKM
EV210B 1.5	1/8 - 27 NPT	1.5	1/16	0.05	0.06	0 to 20	0 to 290	032U6509
EV210B 3	1/4 - 14 NPT	3	1/8	0.3	0.35	0 to 6	0 to 87	032U6511

** Valve typically ordered with coil and connector (see page 22-23)

EV220B 6-22



Servo-operated 2/2-way solenoid valves

- The best water hammer damped solenoid valve
- Normally closed (NC) and normally open (NO) versions
- Long lifetime
- Insensitive to dirt
- Broad range of different body and sealing materials
- Temperature range from brine to steam
- Good external tightness even at high differential pressures



Technical data

Opening differential pressure	0.1 to 10 bar (1.45 to 142 psi)
Ambient temperature	Max. 80°C (176 °F)
Media temperature	-10° to 90°C (14° to 194°F)
Orifice sizes	6 to 22 mm (1/4" to 3/4")
Process connection	1/4" to 1" NPT or BSPP
Body material	Brass or Dezincification Resistant Brass (DZR)
Seal material	EPDM or FKM
Enclosure	Up to IP67 / NEMA 6 (depending on coil and connector)

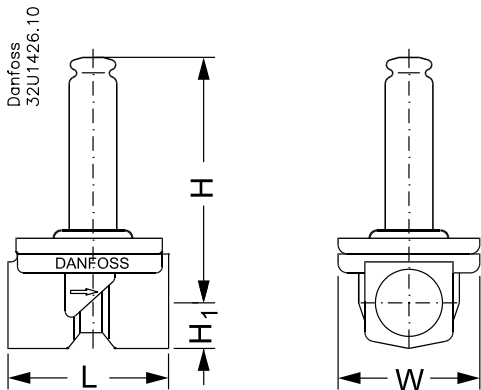

Dimensions and weight

Type	H (NC)		H (NO)		W	
	mm	in	mm	in	mm	in
EV220B 6	73.7	2.9	78.8	3.1	43.2	1.7
EV220B 10	77	3.0	81.3	3.2	48.3	1.9
EV220B 12	77	3.0	-	-	53.3	2.1
EV220B 18	83.8	3.3	-	-	61.0	2.4
EV220B 22	92	3.6	-	-	61.0	2.4

Type	L		H1		Weight	
	mm	in	mm	in	kg	lbs
EV220B 6	45.7	1.8	13.0	0.5	0.23	0.5
EV220B 10	58	2.3	13.0	0.5	0.29	0.6
EV220B 12	62	2.4	13.0	0.5	0.36	0.8
EV220B 18	90	-	18.0	0.7	0.64	1.4
EV220B 22	90	3.5	23.0	0.9	0.95	2.1

Ordering - EV220B 6-22

Versions normally closed

Type	Connection	Orifice size		Flow factor		Opening differential pressure		Code no.**	Code no.**
		mm	in	Kv (m ³ /hr)	Cv (US gal/min)	bar	psi	EPDM	FKM
EV220B 6	1/4 - 18 NPT	6	1/4	0.7	0.8	0.1 to 10	1.45 to 145	032U6513	032U6515
EV220B 6	3/8 - 18 NPT	6	1/4	0.7	0.8	0.1 to 10	1.45 to 145	032U6514	032U6516
EV220B 10	3/8 - 18 NPT	10	3/8	1.5	1.7	0.1 to 10	1.45 to 145	032U6517	032U6519
EV220B 10	1/2 - 14 NPT	10	3/8	1.5	1.7	0.1 to 10	1.45 to 145	032U6518	032U6520
EV220B 12	1/2 - 14 NPT	12	1/2	2.5	2.9	0.3 to 10	4.35 to 145	032U6521	032U6522
EV220B 18	3/4 - 14 NPT	18	3/4	6	7	0.3 to 10	4.35 to 145	032U6523	032U6524
EV220B 22	1 - 11 1/2 NPT	22	7/8	6	7	0.3 to 10	4.35 to 145	032U6525	032U6526

Ordering - EV220B 6-22

Versions normally open

Type	Connection	Orifice size		Flow factor		Opening differential pressure		Code no.	Code no.
		mm	in	Kv (m ³ /hr)	Cv (US gal/min)	bar	psi	EPDM	FKM
EV220B 6	3/8 - 18 NPT	6	1/4	0.7	0.8	0.1 to 10	1.45 to 145	032U6528	032U6529
EV220B 10	1/2 - 14 NPT	10	3/8	0.7	0.8	0.1 to 10	1.45 to 145	-	032U6530

** Valve typically ordered with coil and connector (see page 22-23)

EV220B 15-50



Servo-operated 2/2-way solenoid valves

- The best water hammer damped solenoid valve
- Normally closed (NC) and normally open (NO) versions
- Long lifetime
- Insensitive to dirt
- Broad range of different body and sealing materials
- Temperature range from brine to steam
- Broad range of standard options that include: Isolating diaphragm, manual-operating unit and adjustable equalizing orifice
- Good external tightness even at high differential pressures



Technical data

Opening differential pressure	0.3 to 10 bar (4.35 to 145 psi)
Ambient temperature	Max. 80°C (176°F)
Media temperature	-10° to 120°C (14° to 248 °F)
Orifice sizes	15 to 50 mm (9/16" to 2")
Process connection	1/2" to 2" NPT or BSPP
Body material	Brass, Dezincification Resistant Brass (DZR), Bronze (EV220B 50) or Stainless Steel
Seal material	EPDM, FKM or NBR
Enclosure	Up to IP67 / NEMA 6 (depending on coil and connector)

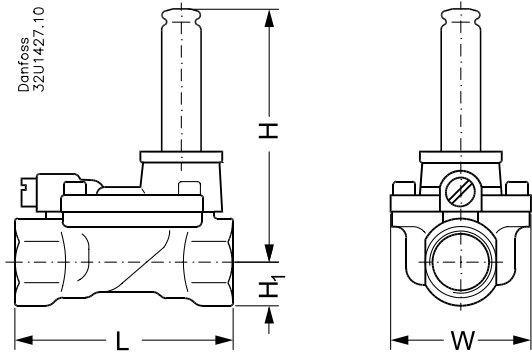

Dimensions and weight

Type	H		H (NO)		W	
	mm	in	mm	in	mm	in
EV220B 15	94.0	3.7	99	3.9	50.8	2.0
EV220B 20	98	3.9	103	4.1	58.0	2.3
EV220B 25	108	4.3	113	4.4	70.0	2.8
EV220B 32	115	4.5	120	4.7	82.0	3.2
EV220B 40	124	4.9	129	5.1	95.0	3.7
EV220B 50	130	5.1	135	5.3	113.0	4.4

Type	L		H1		Weight	
	mm	in	mm	in	kg	lbs
EV220B 15	86.4	3.4	15.0	0.6	0.81	1.8
EV220B 20	94.0	3.7	18.0	0.7	1.0	2.2
EV220B 25	111.8	4.4	22.0	0.9	1.41	3.1
EV220B 32	121.9	4.8	27.0	1.1	2.0	4.4
EV220B 40	132.1	5.2	32.0	1.3	3.22	7.1
EV220B 50	162.6	6.4	37.0	1.5	4.31	9.5

Ordering - EV220B 15-50

Versions with EPDM seal material

Type	Process Connection	Orifice size		Flow factor		Opening differential pressure		Code no.**	Code no.**	Code no.**
		mm	in	Kv (m ³ /hr)	Cv (US Gal/min)	bar	psi	NC, Brass	NO, Brass	NC, St. Steel
EV220B 15	1/2 - 14 NPT	15	9/16	4	4.7	0.3 to 10	4.35 to 145	032U6532	032U6544	032U8550
EV220B 20	3/4 - 14 NPT	20	3/4	8	9.4	0.3 to 10	4.35 to 145	032U6533	032U6545	032U8551
EV220B 25	1 - 11 1/2 NPT	25	1	11	12.3	0.3 to 10	4.35 to 145	032U6534	032U6546	032U8552
EV220B 32	1 1/4 - 11 1/2 NPT	32	1 1/4	18	21	0.3 to 10	4.35 to 145	032U6535	032U6547	032U8553
EV220B 40	1 1/2 - 11 1/2 NPT	40	1 1/2	24	28	0.3 to 10	4.35 to 145	032U6536	032U6548	032U8554
EV220B 50	2 - 11 1/2 NPT	50	2	40	46.8	0.3 to 10	4.35 to 145	032U6537	032U6549	032U8555

Ordering - EV220B 15-50

Versions with FKM seal material

Type	Process Connection	Orifice size		Flow factor		Opening differential pressure		Code no.**	Code no.**	Code no.**
		mm	in	Kv (m ³ /hr)	Cv (US Gal/min)	bar	psi	NC, Brass	NO, Brass	NC, St. Steel
EV220B 15	1/2 - 14 NPT	15	9/16	4	4.7	0.3 to 10	4.35 to 145	032U6538	032U6550	032U8556
EV220B 20	3/4 - 14 NPT	20	3/4	8	9.4	0.3 to 10	4.35 to 145	032U6539	032U6551	032U8557
EV220B 25	1 - 11 1/2 NPT	25	1	11	12.3	0.3 to 10	4.35 to 145	032U6540	032U6552	032U8558
EV220B 32	1 1/4 - 11 1/2 NPT	32	1 1/4	18	21	0.3 to 10	4.35 to 145	032U6541	032U6553	032U8559
EV220B 40	1 1/2 - 11 1/2 NPT	40	1 1/2	24	28	0.3 to 10	4.35 to 145	032U6542	032U6554	032U8560
EV220B 50	2 - 11 1/2 NPT	50	2	40	46.8	0.3 to 10	4.35 to 145	032U6543	032U6555	032U8561

** Valve typically ordered with coil and connector (see page 22-23)

EV225B



Servo-operated 2/2-way solenoid valves for steam

- Superior in design and performance of big and expensive piston/cylinder design
- No sticking caused by an ordinary piston/cylinder design
- No breakdown caused by aggressive steam produced from technical water
- No internal leakages caused by broken down seats
- No external leakages caused by ordinary sealing material



Technical data

Opening differential pressure	0.2 to 10 bar (2.9 to 145 psi)
Ambient temperature	Max. 40°C (104 °F)
Media temperature	184°C (364°F)
Orifice sizes	6 to 25 mm (1/4" to 1")
Process connection	1/4" to 1" NPT or BSPP
Body material	Dezincification Resistant Brass (DZR)
Seal material	PTFE
Enclosure	Up to IP67 / NEMA 6 (depending on coil and connector)

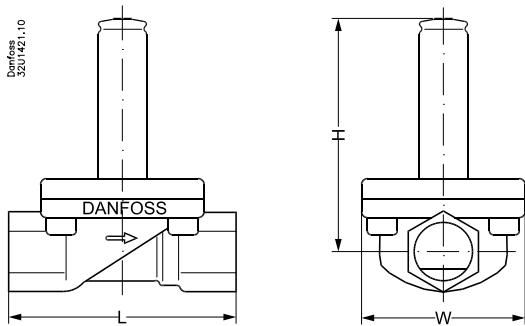

Dimensions and weight

Type	H		W		L		Weight	
	mm	in	mm	in	mm	in	kg	lbs
EV215B 3	85.5	3.4	34.0	1.3	38.0	1.5	0.25	0.56
EV225B 6	96	3.8	46.0	1.8	62.0	2.4	0.35	0.78
EV225B 10	96	3.8	46.0	1.8	62.0	2.4	0.37	0.82
EV225B 15	97.5	3.8	56.0	2.2	81.0	3.2	0.44	0.96
EV225B 20	104	4.1	72.0	2.8	98.0	3.9	0.64	1.4
EV225B 25	112	4.4	72.0	2.8	106	4.2	0.82	1.8

Ordering - EV225B

Type	Process Connection	Orifice size		Flow factor		Opening differential pressure		Code no.**
		mm	in	Kv (m ³ /hr)	Cv (US Gal/min)	bar	psi	
EV215B 3	1/8 - 27 NPT	3	1/8	0.3	0.35	0 to 10	0 to 145	032U3688
EV225B 6	1/4 - 18 NPT	6	1/4	0.9	1.05	0.2 to 10	2.9 to 145	032U3689
EV225B 10	3/8 - 18 NPT	10	3/8	2.2	2.6	0.2 to 10	2.9 to 145	032U3690
EV225B 10	1/2 - 14 NPT	10	3/8	2.2	2.6	0.2 to 10	2.9 to 145	032U3691
EV225B 15	1/2 - 14 NPT	15	9/16	3.0	3.5	0.2 to 10	2.9 to 145	032U3692
EV225B 20	3/4 - 14 NPT	20	3/4	5.0	5.9	0.2 to 10	2.9 to 145	032U3693
EV225B 25	1 - 11 1/2 NPT	25	1	6.0	7	0.2 to 10	2.9 to 145	032U3694

** Valve typically ordered with coil and connector (see page 22-23)

EV250B



Assisted lift operated 2/2-way solenoid valves

- Optimum water hammer damped solenoid valve
- High opening degree at zero or low differential pressures
- The easy choice if you don't have any pressure information
- Especially applicable for aggressive low-pressure steam
- Good external tightness even at high differential pressures



Technical data

Opening differential pressure	0 to 10 bar (0 to 145 psi)
Ambient temperature:	Max. 80°C (176 °F)
Media temperature	-10° to 90°C (14° to 194 °F)
Orifice sizes	10 to 22 mm (3/8" to 1")
Process connection	1/2" to 1" NPT or BSPP
Body material	Dezincification Resistant Brass (DZR)
Seal material	EPDM or FKM

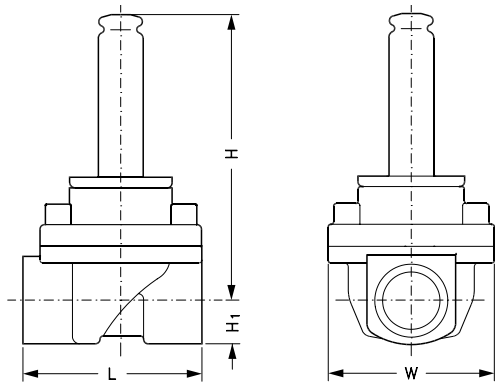

Danfoss
320142510

Dimensions and weight

Type	H		W		L		H1		Weight	
	mm	in	mm	in	mm	in	mm	in	kg	lbs
EV250B 10	93.5	3.7	52.5	2.1	58.0	2.3	12.7	0.5	0.59	1.3
EV250B 12	93.5	3.7	52.5	2.1	58.0	2.3	12.7	0.5	0.59	1.3
EV250B 18	93.5	3.7	58.0	2.3	90.0	3.5	17.8	0.7	0.82	1.8
EV250B 22	100	3.9	58.0	2.3	90.0	3.5	22.9	0.9	1.09	2.4

Ordering - EV250B

Type	Process Connection	Orifice size		Flow factor		Operating differential pressure		Code no.**	Code no.**
		mm	in	Kv (m ³ /hr)	Cv (US Gal/min)	bar	psi	EPDM	FKM
EV250B 10BD	3/8 - 18 NPT	9.5	3/8	2.5	2.9	0 to 10	0 to 145	032U5260	032U5261
EV250B 12BD	1/2 - 14 NPT	12	1/2	4	4.7	0 to 10	0 to 145	032U5262	032U5263
EV250B 18BD	3/4 - 14 NPT	18	3/4	6	7.0	0 to 10	0 to 145	032U5264	032U5265
EV250B 22BD	1 - 11 1/2 NPT	22	1	7	8.2	0 to 10	0 to 145	032U5266	032U5267

** Valve typically ordered with coil and connector (see page 22-23)

EV260B



Servo-operated 2-way proportional solenoid valves

- High Performance robust design
- For stepless flow regulation
- Valve can be set to any position between completely closed and completely open
- For neutral liquids and gases such as water, oil and air
- Linear characteristic throughout the regulation range
- Closes on power failure (fail-safe function)

Technical data

Opening differential pressure	0.5 to 10 bar (7 to 145 psi)
Ambient temperature:	Max 49 °C (120 °F)
Media temperature	-10 to 80 °C (14 to 176 °F)
Orifice sizes	6 to 20 mm (1/4" to 3/4")
Process connection	NPT 1/4" to 3/4"
Body material	Brass
Seal material	PTFE/NBR/CR
Enclosure	IP 67 / NEMA 6
Applicable coil types	BK / BL / BM (see coil section page)

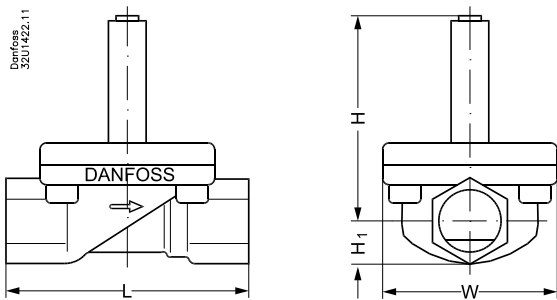

Dimensions and weight

Type	H		W		L		H1		Weight	
	mm	in	mm	in	mm	in	mm	in	kg	lbs
EVSIM 6	71	2.8	69	2.7	61	2.4	13	0.5	0.50	1.1
EVSIM 10	71	2.8	69	2.7	61	2.4	13	0.5	0.36	0.8
EVSIM 15	74	2.9	69	2.7	81	3.2	15	0.6	0.64	1.4
EVSIM 20	79	3.1	69	2.7	99	3.9	18	0.7	1.27	2.8

Ordering - EV260B

Type	Process Connection	Orifice size		Flow factor		Operating differential pressure		Code no.**
		mm	in	Kv (m ³ /hr)	Cv (US Gal/min)	bar	psi	FKM
EV260B 6	1/4 to 18 NPT	6	1/4	0.8	2.94	0.5 to 10	7 to 145	032U8062
EV260B 6	3/8 to 18 NPT	6	1/4	0.8	2.94	0.5 to 10	7 to 145	032U8063
EV260B 10	3/8 to 18 NPT	10	3/8	1.3	1.52	0.5 to 10	7 to 145	032U8064
EV260B 10	1/2 to 14 NPT	10	3/8	1.3	1.52	0.5 to 10	7 to 145	032U8065
EV260B 15	1/2 to 14 NPT	15	9/16	2.1	2.5	0.5 to 10	7 to 145	032U8066
EV260B 20	3/4 to 14 NPT	20	3/4	5	6	0.5 to 10	7 to 145	032U8067

** Valve typically ordered with coil and connector (see page 22-23)

Accessories and spare part kits for solenoid valves

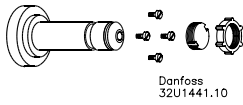

Danfoss
32U1441.10

Isolating diaphragm kits for EV210B and EV220B

Seal material	Code no.
EPDM	042U1009
FKM	042U1010

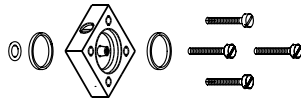

Danfoss
32U1432.10

Manual override kits for EV210B and EV220B

Material	Code no.
Brass	032U0150
St. Steel	032U0149

Assembled Normally Open (NO) units for EV210B and EV220B

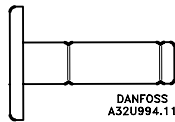

DANFOSS
A32U994.11

Seal material	Code no.	
	FKM	EPDM
EV210B 1.5 - 3	032U2004	032U2005
EV220B 6	032U0166	032U0165
EV220B 10	032U0167	
EV220B 15-50	032U0295	032U0296

Assembled Normally Closed (NC) units For EV210B

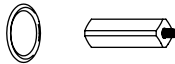

Danfoss
32U1445.10

Type	Code no.	Code no.
	FKM	EPDM
EV210B 1.5, 2 and 3	032U2003	032U6000
EV210B 6 and 10	032U2011	032U2006
EV210B 1.5 NO and 3 NO	032U2004	032U2005

For EV220B 6-22

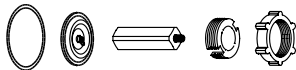

Danfoss
32U1446.10

Type	Code no.	Code no.
	EPDM	FKM
EV220B 6	032U1062	032U1063
EV220B 10	032U1065	032U1066
EV220B 12	032U1068	032U1067
EV220B 18 and 22	032U1070	032U1069

For EV220B 15-50

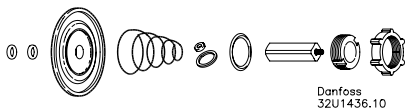

Danfoss
32U1436.10

Type	Code no.	Code no.	Code no.	Code no.
	EPDM	FKM	EPDM	FKM
	Brass	Brass	St. Steel or DZR brass	St. Steel or DZR brass
EV220B 15	032U1071	032U1072	032U6320	032U6326
EV220B 20	032U1073	032U1074	032U6321	032U6327
EV220B 25	032U1075	032U1076	032U6322	032U6328
EV220B 32	032U1077	032U1078	032U6323	032U6329
EV220B 40	032U1079	032U1080	032U6324	032U6330
EV220B 50	032U1081	032U1082	032U6325	032U6331

Spare part kits for solenoid valves

For EV215B and EV225B

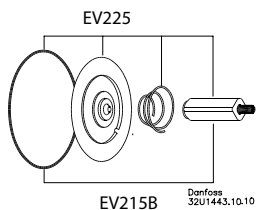

Type	Code no.
EV215B 3	032U3174
EV225B 6 and 10	032U3175
EV225B 15	032U3176
EV225B 20	032U3177
EV225B 25	032U3178

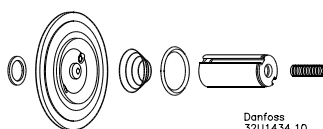

For EV220A

Type	Code no.	Code no.	Code no.
	EPDM	NBR	FKM
EV220A 6B and 10B	042U1000	042U1001	042U1002
EV220A 12B and 14B	042U1003	042U1004	042U1005
EV220A 18B and 22B	042U1006	042U1007	042U1008

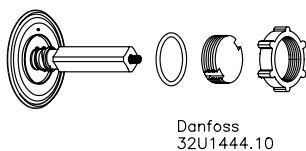

For EV250B

Type	Code no.	Code no.
	EPDM	FKM
EV250B 10 and 12	032U5277	032U5278
EV250B 18 and 22	032U5279	032U5280

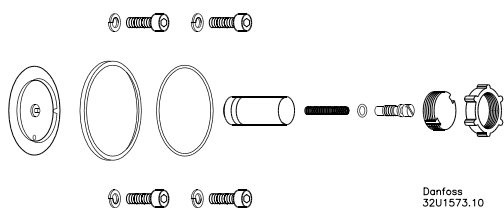

For EV260B

Type	Code no.
<i>in</i>	
1/4"	032U8039
3/8"	032U8040
9/16"	032U8041
3/4"	032U8042

Coils for solenoid valves



BT (junction box)

for EV210B, EV215B, EV220B, EV225B and EV250B

Voltage	Frequency	Ambient temperature		Power consumption	Enclosure	Code no.
		V_{ac}	Hz			
24	50 / 60	-40 to 50	-40 to 122	14	54 / 2	018F7683
110	50 / 60	-40 to 50	-40 to 122	14	54 / 2	018F7682
120	60	-40 to 50	-40 to 122	14	54 / 2	
208 to 240	60	-40 to 50	-40 to 122	14	54 / 2	018F7681
230	50	-40 to 50	-40 to 122	14	54 / 2	



BU (conduit boss)

for EV210B, EV215B, EV220B, EV225B and EV250B

Voltage	Frequency	Ambient temperature		Power consumption	Enclosure	Code no.
		V_{ac}	Hz			
24	50 / 60	-40 to 50	-40 to 122	14	66 / 4	018F7693
110	50 / 60	-40 to 50	-40 to 122	14	66 / 4	018F7692
120	60	-40 to 50	-40 to 122	14	66 / 4	
208 to 240	60	-40 to 50	-40 to 122	14	66 / 4	018F7691
230	50	-40 to 50	-40 to 122	14	66 / 4	



BY (clip-on)

for EV210B, EV220B and EV250B

Voltage	Frequency	Ambient temperature		Power consumption	Enclosure	Code no.
		V_{ac}	Hz			
24	50 / 60	-40 to 50	-40 to 122	14	65* / 4	018F7655
110	50 / 60	-40 to 50	-40 to 122	14	65* / 4	018F7663
208 to 240	60	-40 to 50	-40 to 122	14	65* / 4	018F7658
230	50	-40 to 50	-40 to 122	14	65* / 4	

*When used with connector

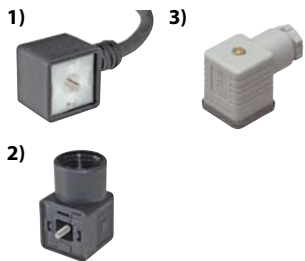

Connectors for coils

for BY and BA coils

Description	Enclosure	Code no.
	IP / NEMA	
1) DIN Plug with 1.22 m (4') cable	65 / 13	042N0120
2) DIN Plug with 1/2 - 14 NPT conduit	65 / 13	042N0154
3) DIN Plug Pg 11	65 / 13	042N0156

Coils for solenoid valves



BA (direct current)

for EV210B, EV220B and EV250B

Voltage	Power consumption	Ambient temperature		Enclosure	Code no.
		max. °C	max. °F		
VDC	W			IP / NEMA	
12	15	50	104	65 / 4	042N7550
24	15	50	104	65 / 4	042N7551



BE (direct current)

for EV210B, EV220B and EV250B

Voltage	Power consumption	Ambient temperature		Enclosure	Code no.
		max. °C	max. °F		
VDC	W			IP / NEMA	
12	18	50	122	67 / 6	018F6756
24	18	50	122	67 / 6	018F6757



BR (direct current for steam)

for EV215B and EV225B

Voltage	Power consumption	Ambient temperature		Enclosure	Code no.
		max. °C	max. °F		
VDC	W			IP / NEMA	
24	17	40	104	54 / 2	032K140902



BK/BL/BM

for EV260B

Voltage	Power consumption	Ambient temperature		Enclosure	Pilot signal	Code no.
		max. °C	max. °F			
VDC	W			IP / NEMA		
24±10% full-wave rectified	20	50	122	67/6	300 to 600 mA	18Z6987
21 to 30	20	50	122	67/6	4 to 20mA	018Z0291
21 to 30	20	50	122	67/6	0 to 10V	018Z0290

AVTA

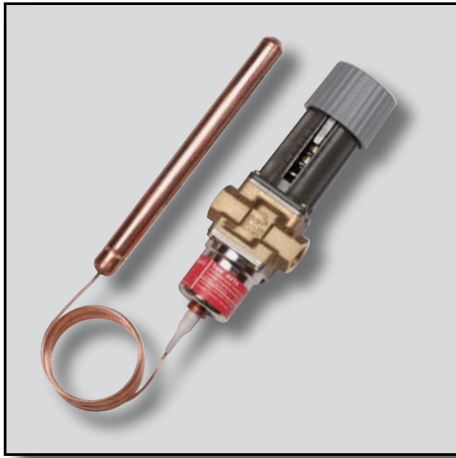

Thermostatically operated valves with capillary sensor

- Self acting - needs no electricity
- Exact temperature control
- Insensitive to dirt - the reliable fit and forget valve
- Insensitive to pressures
- From zero differential pressure
- Good external tightness even at high differential pressures
- Broad range of different body materials, connections and temperatures



Technical data

Media temperature	-25° to 130°C (-13° to 266°F)
Orifice sizes	15 to 25 mm (9/16" to 1")
Process connection	1/2" to 1" NPT or BSPP
Body material	Brass or Stainless Steel
Charge type	Universal, adsorption or mass

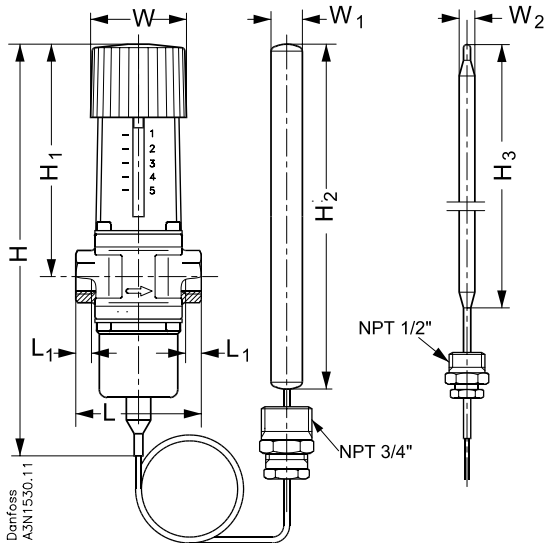

Dimensions and weight

Type	H		H1		H2		H3		W	
	cm	in	cm	in	cm	in	cm	in	cm	in
AVTA 15	24.13	9.5	13.21	5.2	21.01	8.27	16.0/19.05	6.3/7.5	5.59	2.2
AVTA 20	24.13	9.5	13.21	5.2	21.01	8.27	16.0/19.05	6.3/7.5	5.59	2.2
AVTA 25	25.14	9.9	13.72	5.4	21.01	8.27	16.0/19.05	6.3/7.5	5.59	2.2

Type	W1		W2		L		L1		Weight	
	cm	in	cm	in	cm	in	cm	in	kg	lbs
AVTA 15	1.78	0.7	0.94	0.37	7.11	2.8	1.52	0.6	1.45	3.2
AVTA 20	1.78	0.7	0.94	0.37	9.14	3.6	1.52	0.6	1.50	3.3
AVTA 25	1.78	0.7	0.94	0.37	9.50	3.74	1.52	0.8	1.63	3.6

Ordering - AVTA

Versions with universal charge type, capillary tube length equals 2.01 m (6'6")

Type	Process Connection	Regulation range		Sensor temperature		Orifice size		Flow factor		Code no.
		°C	°F	max °C	max °F	mm	in	Kv (m ³ /hr)	Cv (US Gal/min)	
AVTA 15	1/2 - 14 NPT	0 to 30	32 to 86	57	135	15	9/16	1.87	2.2	003N6132
AVTA 20	3/4 - 14 NPT	0 to 30	32 to 86	57	135	20	3/4	3.4	4	003N7132
AVTA 25	1 - 11 1/2 NPT	0 to 30	32 to 86	57	135	25	1	5.44	6.4	003N8132
AVTA 15	1/2 - 14 NPT	25 to 65	77 to 149	90	194	15	9/16	1.87	2.2	003N6162
AVTA 20	3/4 - 14 NPT	25 to 65	77 to 149	90	194	20	3/4	3.4	4	003N7162
AVTA 25	1 - 11 1/2 NPT	25 to 65	77 to 149	90	194	25	1	5.44	6.4	003N8162
AVTA 15	1/2 - 14 NPT	50 to 90	122 to 194	125	257	15	9/16	1.87	2.2	003N6182
AVTA 20	3/4 - 14 NPT	50 to 90	122 to 194	125	257	20	3/4	3.4	4	003N7182
AVTA 25	1 - 11 1/2 NPT	50 to 90	122 to 194	125	257	25	1	5.44	6.4	003N8182

Ordering - AVTA

Versions with adsorption charge type, capillary tube length equals 2.32 m (7'6")

Type	Process Connection	Regulation range		Sensor temperature		Orifice size		Flow factor		Code no.
		°C	°F	max °C	max °F	mm	in	Kv (m ³ /hr)	Cv (US Gal/min)	
AVTA 15	1/2 - 14 NPT	10 to 80	50 to 176	130	266	15	9/16	1.87	2.2	003N6115
AVTA 20	3/4 - 14 NPT	10 to 80	50 to 176	130	266	20	3/4	3.4	4	003N7120
AVTA 25	1 - 11 1/2 NPT	10 to 80	50 to 176	130	266	25	1	5.44	6.4	003N8125

Accessories and spare parts for AVTA

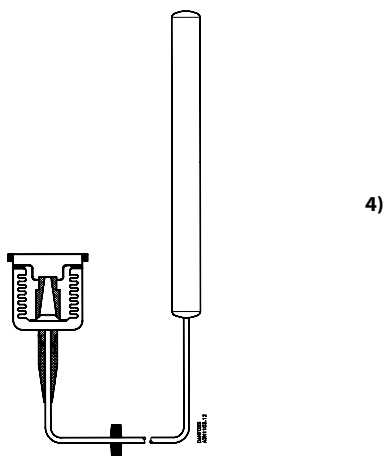
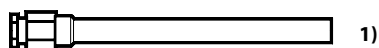

1) Sensor pocket, Ø0.7", 3/4 - 14 NPT	Brass	003N0051
1) Sensor pocket, Ø0.7", 3/4 - 14 NPT	Stainless Steel	003N0053
2) Mounting bracket	-	003N0388
3) Capillary tube gland	1/2 - 14 NPT	003N0157
3) Capillary tube gland	3/4 - 14 NPT	003N0056

4) service elements

Sensor charge	Regulation range		Capillary tube length		Code no.
	°C	°F	m	ft	
Adsorption	10 to 80	50 to 176	2.32	7.5	003N0278
Universal	0 to 30	32 to 86	2.01	6.5	003N0075
Universal	0 to 30	32 to 86	5.03	16.42	003N0077
Universal	25 to 65	77 to 149	2.01	6.5	003N0078
Universal	25 to 65	77 to 149	5.03	16.42	003N0080
Universal	25 to 65	77 to 149	2.01 armored	6.5 armored	003N0063
Universal	25 to 65	77 to 149	3.05	10	003N0079
Universal	50 to 90	122 to 194	2.01	6.5	003N0062
Mass	0 to 30	32 to 86	2.01	6.5	003N0066
Mass	25 to 65	77 to 149	2.01	6.5	003N0091
Mass	25 to 65	77 to 149	5.03	16.42	003N0068